

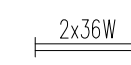





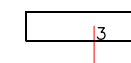
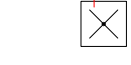
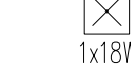

# LEGENDA

-  PLAFONIERA CON TUBI FLUORESCENTI 2x36W
-  APPARECCHIO A PLAFONE LED 1000 lm – PART. 1
-  APPARECCHIO A SOSPENSIONE A LED 4900 lm – PART. 2
-  LAMPADA AUTONOMA DI SICUREZZA 1x11W
-  LAMPADA AUTONOMA DI SICUREZZA 1x18W
-  PULSANTE
-  PULSANTE CON SPIA LUMINOSA
-  INTERRUTTORE UNIPOLARE
-  APPARECCHI IN ESECUZIONE PROTETTA
-  TIRANTE BAGNO CON RONZATORE
-  APPARECCHIO ILLUMINANTE A PARETE

Part.2

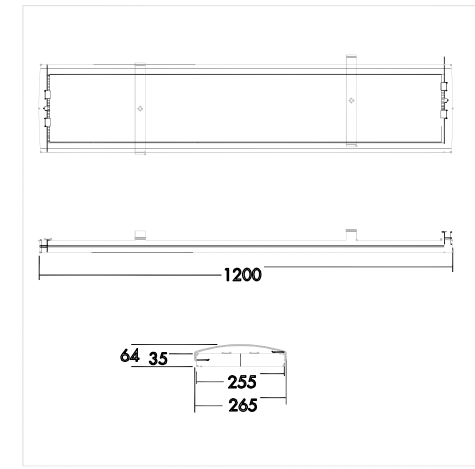

APPARECCHIO A SOSPENSIONE LED 4200 lm

Part.1

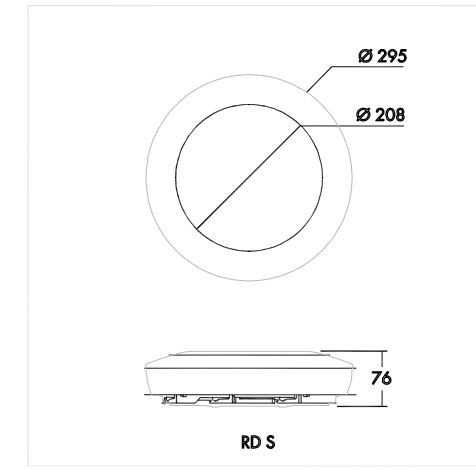

APPARECCHIO A PLAFONE LED 1000 lm

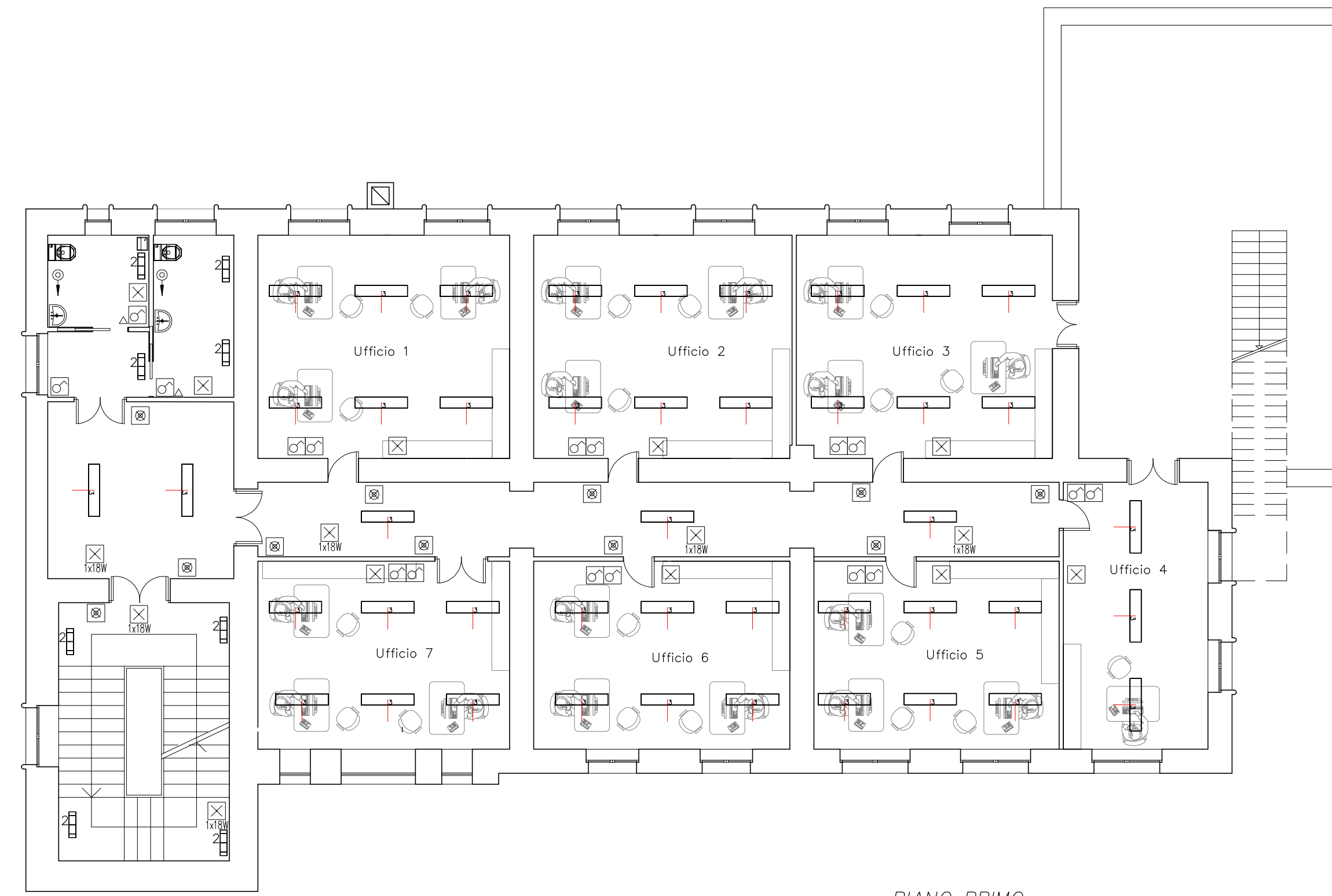

PIANO PRIMO

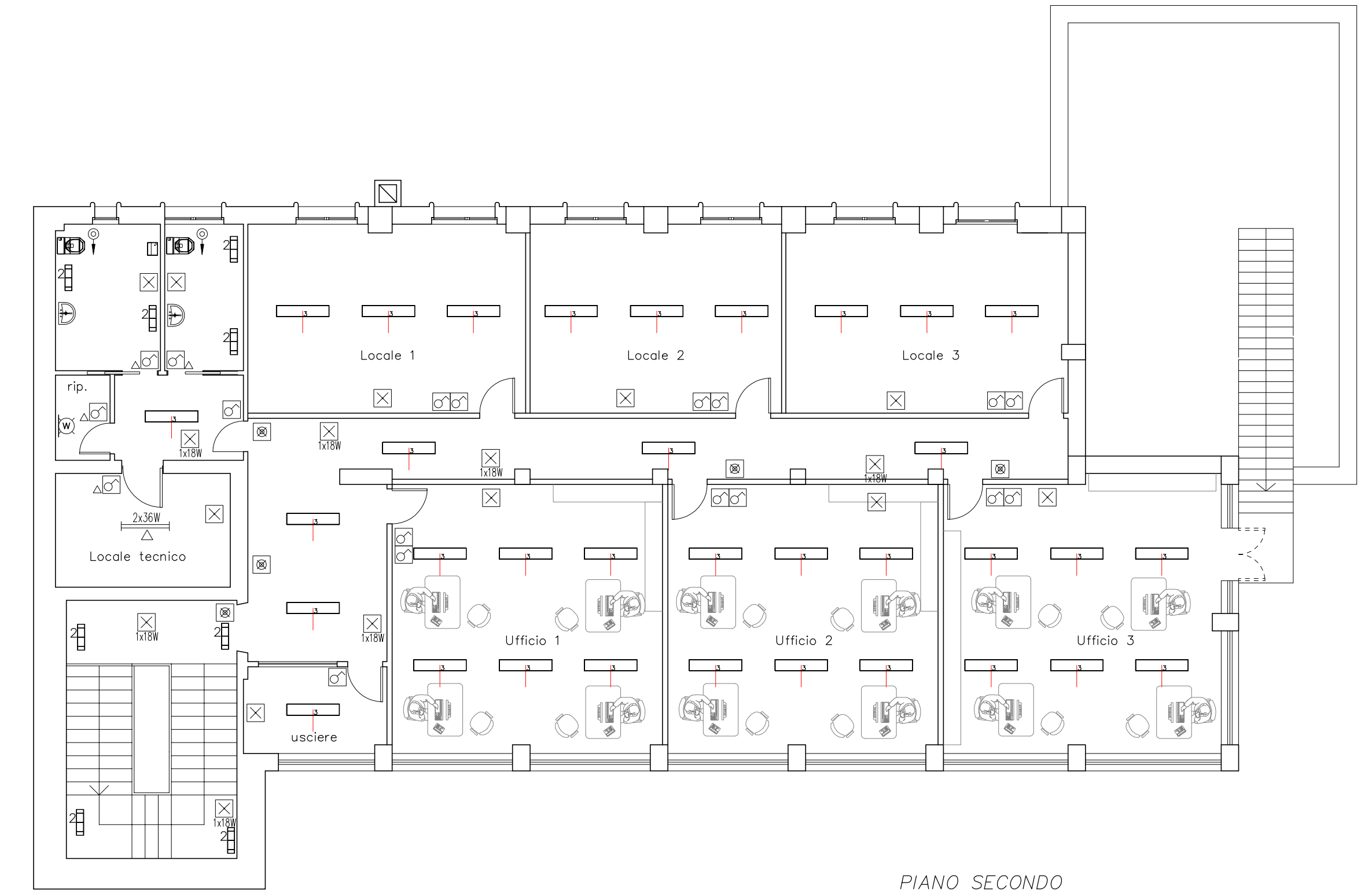

PIANO SECONDO

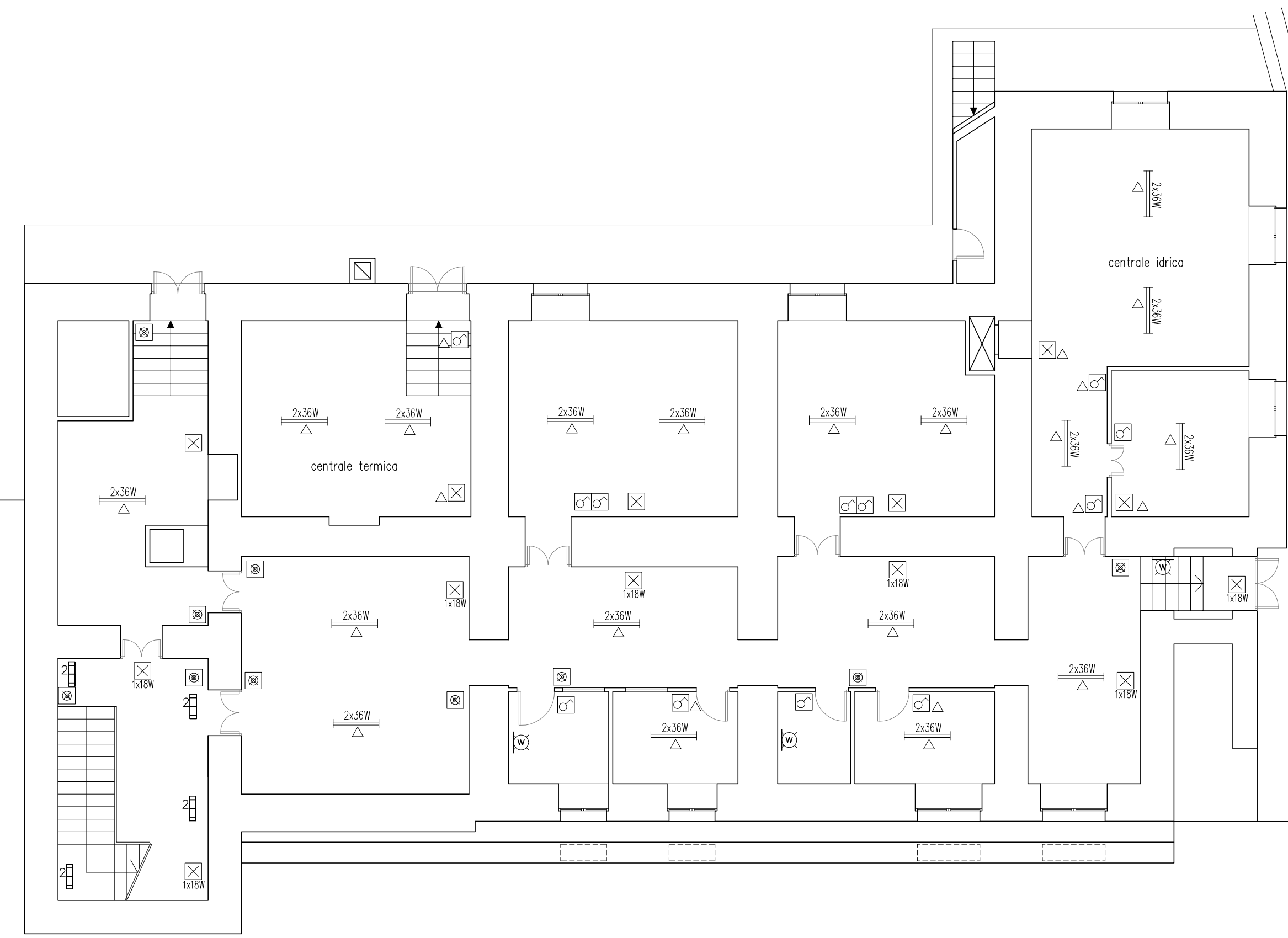

PIANO SEMINTERRATO

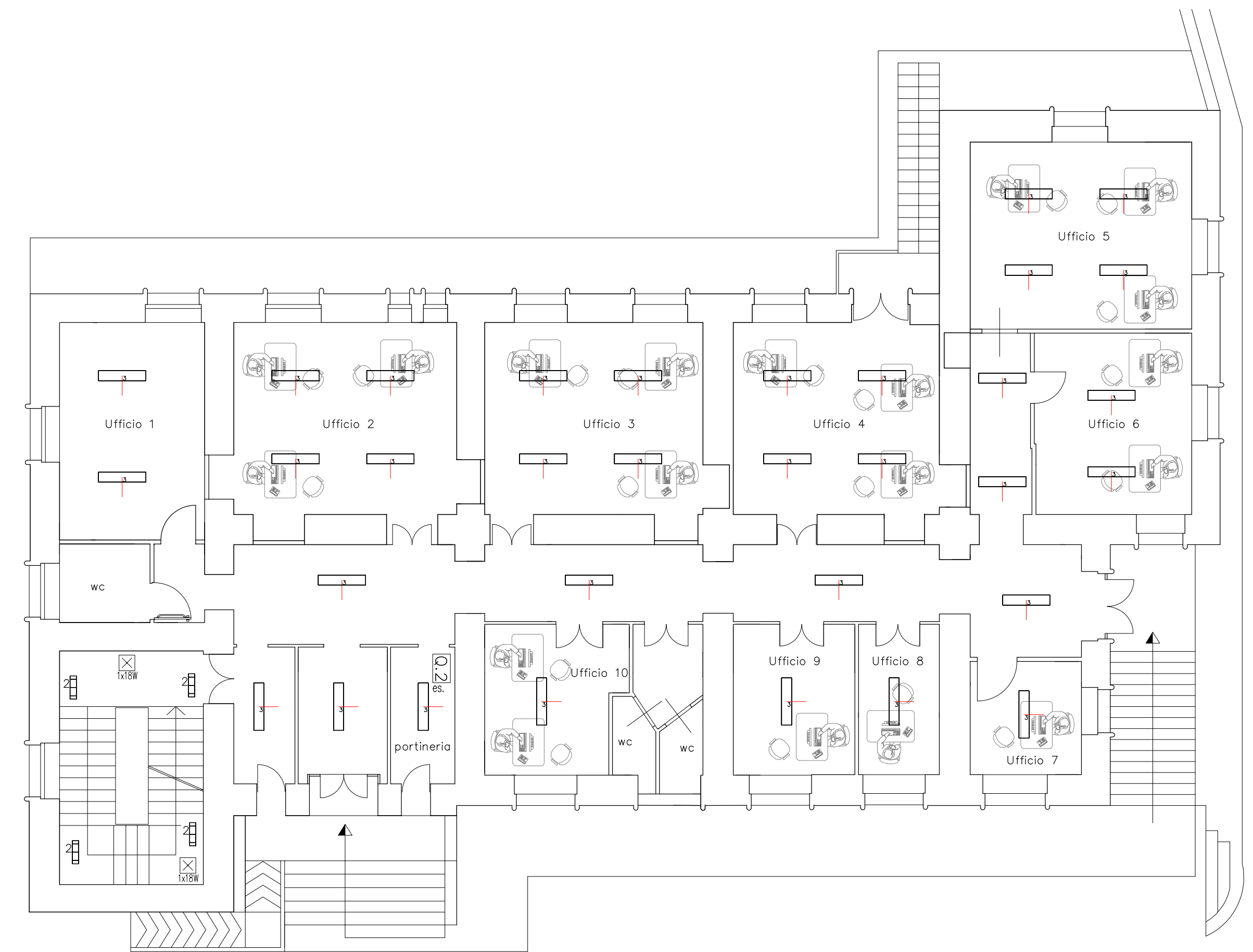

PIANO RIALZATO

Via Tre Palazzi

Via Roma

## COMUNE DI ENNA

AREA 2 – TECNICA e di PROGRAMMAZIONE URBANISTICA

PROGETTO DI ADEGUAMENTO DELL'IMPIANTO ELETTRICO DEL PALAZZO EX ONMI DI ENNA ALLA NORME DI SICUREZZA ANTINCENDIO

data: nov. 2015

elaborato:  
**6**

SCHEMA TOPOGRAFICO IMPIANTO ILLUMINOTECNICO

scala:  
1:100

progettista	direttore dei lavori	RUP	impresa
ing. Benedetto Giummulè			